

THE BROADWAY



TOTAL SQ. FT. = 1203
3 BED / 2 BATH
6' X 14' COVERED FRONT PORCH
6' X 6' SIDE STOOP

FEATURES

**WALK-IN CLOSET & FULL BATH IN
MASTER BEDROOM**
FRONT PORCH & SIDE STOOP

HIGHLIGHTS

LARGE LIVING ROOM
LARGE KITCHEN SPACE
ENERGY EFFICIENT

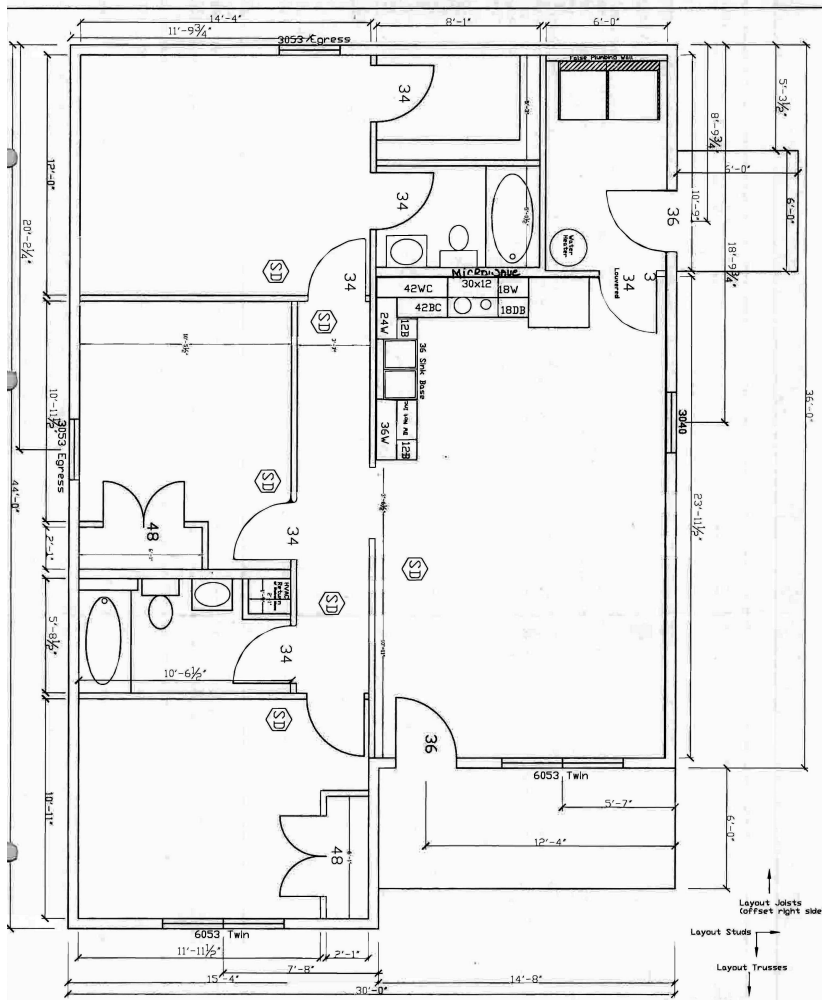

HDAHOMES.ORG

